



Mini Cooper Leather Door Pull Kit Installation Instructions

Part Number 101-495

440 Rutherford St. P.O. Box 847 Goleta, CA 93117
1-888-642-8295 • FAX 805-692-2525 • www.mossmotors.com

Note: If also installing Moss part# 101-485 Door Armrest Kit, 101-495 Leather Door Pull Kit must be installed first.

1) Wrap the larger leather piece around the horizontal door pull. Start attaching the Velcro at the front and work your way back. See Illustration 1.



Illustration 1

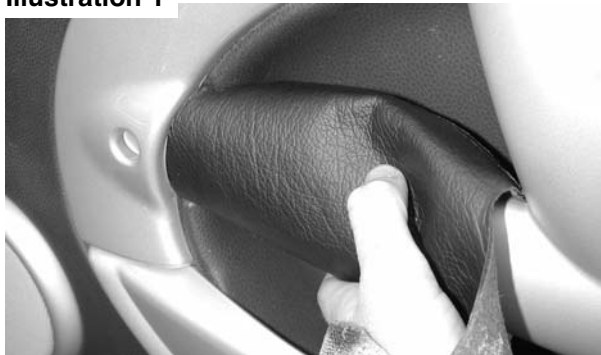

2) Wrap the smaller piece of leather around the vertical part of the door pull. The "V" should be on the front bottom side of the door pull. Attach Velcro starting at the top and working your way down. See Illustration 2.



Illustration 2



Leather Door Pull Installation Instructions

3) Go back and adjust Velcro as needed to get any bunches out of the leather. Use a small screwdriver, or wooden dowel to **gently** push leather under various parts of the door panel. Be careful not to puncture the leather. See Illustration 3.



Illustration 3



4) Repeat for this process for the other side.

5) Enjoy your new Mini Cooper and Mini Cooper S leather door pull kit! Please see MossMini.com for all your Mini Cooper and Mini Cooper S performance and accessory needs.

